

Women in Engineering Day 2017

Women in Engineering Day Student Schedule

Friday, October 20, 2017

7:45-8:15 am	Check-in Registration	*IRIC Atrium
8:15-8:30 am	Welcome	IRIC Atrium
8:45-9:00 am	Challenge Instructions	Litehouse (Kibbie Dome)
9:00-9:30 am	Challenge Planning Phase I	Litehouse (Kibbie Dome)
9:30-11:15 am	Challenge Planning Phase II	Litehouse (Kibbie Dome)
11:15 am-12:00 pm	Design-Test-Build Challenge Debrief	Litehouse (Kibbie Dome)
12:15-1:00 pm	Lunch (provided)	HUB (Formerly Bob's Place)
1:00-2:00 pm	Engineering Lab Tours (meet in alley **JEB & GJL)	Engineering Labs
2:00-3:00 pm	Keynote speaker Susan Linch – UI Civil Engineering Alumnae '94 Title: When someone tells you that you can't, find the voice who says you can	IRIC Atrium
3:00-3:30 pm	Awards & Scholarships	IRIC Atrium
3:30 pm	Visit Vandal Store (optional)	Vandal Store

Vandal store hours M-F 8 am-6 pm, Saturday 9 am- 5 pm, Sunday 10 am-4 pm

*IRIC = Integrated Research and Innovation Center

**JEB = Janssen Engineering Building, GGL= Gauss-Johnson Engineering Building



Women in Engineering Day Parent/Chaperone Schedule

Friday, October 20, 2017

7:45-8:15 am	Check-in Registration	*IRIC Atrium
8:15-8:30 am	Welcome	IRIC Atrium
8:45-9:30 am	Information Sessions:	IRIC, room 305
	<ul style="list-style-type: none"> ▪ Housing & Residence Life, Bart Sonnenberg, Assistant Director for Residential Engagement ▪ Financial Aid & Scholarships, Kelsey Lavelle, Financial Aid Counselor for Scholarships ▪ University Honors Program, Sandra Reineke, Director 	
9:30-10:00 am	Break	Litehouse (Kibbie Dome)
9:45-10:45 am	Student Ambassador Panel	TBA
11:00 am-12:00 pm	Campus tour	Bruce Pitman Center (Campus Visit Office)
12:15-1:00 pm	Lunch (provided)	HUB (Formally Bob's Place)
1:00-2:00 pm	Engineering Lab Tour (meet in alley **JEB & GJL)	Engineering Labs
2:00-3:00 pm	Keynote speaker: Susan Linch – UI Civil Engineering Alumnae '94 Title: When someone tells you that you can't, find the voice who says you can	IRIC Atrium
3:00-3:30 pm	Awards & Scholarships	IRIC Atrium
3:30 pm	Visit Vandal Store (optional)	Vandal Store

Vandal store hours M-F 8 am-6 pm, Saturday 9 am- 5 pm, Sunday 10 am-4 pm

*IRIC = Integrated Research and Innovation Center

**JEB = Janssen Engineering Building, GGL= Gauss-Johnson Engineering Building

COLLEGE OF ENGINEERING COMPLEX

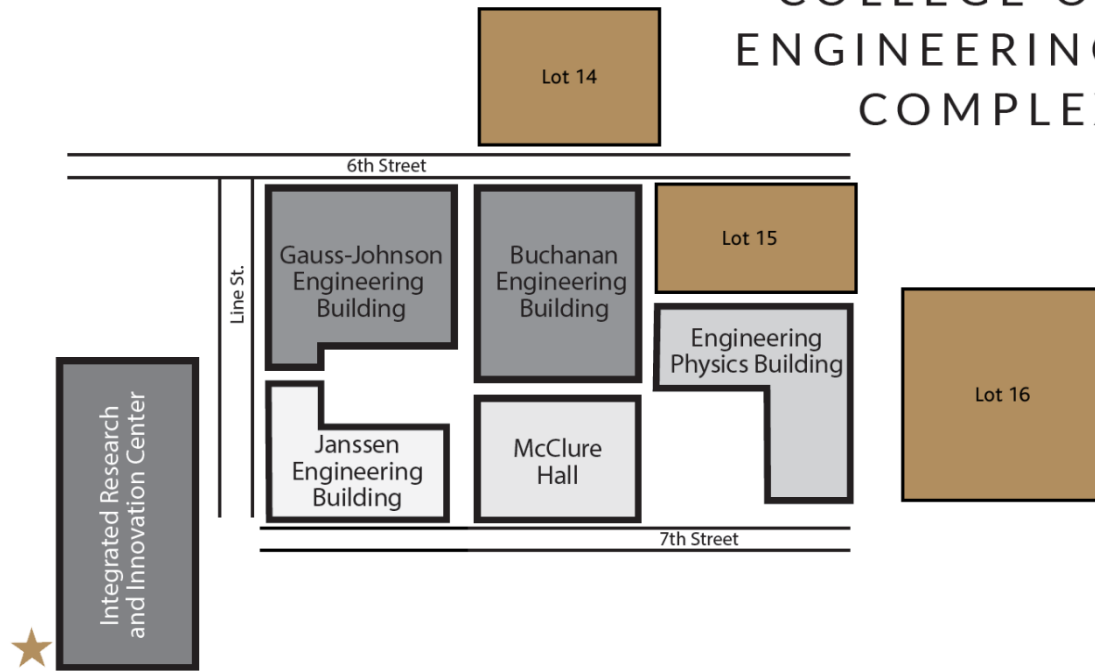

PARKING

Parking passes will be made available in **Lot 16**. A Women in Engineering Day volunteer/staff member will be in Lot 16 to provide parking passes. Passes can be used in Lots 14-16 or any other campus Gold lots. Lots 14-16 are closet to UI Engineering. A complete campus map is also attached.

FRIDAY CHECK-IN INFORMATION

All Women in Engineering Day participants must check-in at the registration table in the Integrated Research and Innovation Center (IRIC), west side first floor entrance.

WAIVERS

All participants must complete and return a University of Idaho Activity Waiver. The waiver form is attached and can also be found at <http://www.uidaho.edu/engr/events/wie/for-participants>

THURSDAY ARRIVALS & GENERAL QUESTIONS

Marie Wagner

Student Services and Programs Coordinator

Preferred Contact: mariew@uidaho.edu

(208) 885-6479

DRIVING DIRECTIONS

ARRIVING FROM THE SOUTH - Proceed north on US 95 into Moscow to 6th Street. Turn left on 6th Street and drive west until you see the gold parking lot #14 on your right (about 5 blocks). Parking is available in gold lot #14 or across the street in gold lot #15 or #16. Look for the **WIE volunteer in lot #16** who will give you your parking permit, scratch off the correct date and place it in your window. Proceed to the IRIC first floor west side entrance to check in.

ARRIVING FROM THE NORTH - Proceed south on US 95 into Moscow to 6th Street. Turn right on 6th Street and drive west until you see the gold parking lot #14 on your right (about 5 blocks). Parking is available in gold lot #14 or across the street in gold lot #15 or #16. Look for the **WIE volunteer in lot #16** who will give you your parking permit, scratch off the correct date and place it in your window. . Proceed to the IRIC first floor west side entrance to check in.

ARRIVING FROM THE WEST (Washington/Pullman direction) - Proceed east past the Palouse Empire Mall to Line Street (third traffic light). Turn right on Line Street, drive three blocks and take a left on 6th Street. Go one block until you see the gold parking lot #14 on your left. Parking is available in gold lot #14 or across the street in gold lot #15 or #16. Look for the **WIE volunteer in lot #16** who will give you your parking permit, scratch off the correct date and place it in your window. Proceed to the IRIC first floor west side entrance to check in.

SHORT-TERM PARKING If you are just dropping off a student for registration, metered parking is available in Lot #18 adjacent to the Bruce M. Pitman Center (see campus map) or at the UI Bookstore across the street from Lot #18 between 6:00am and 5:00pm.

CAMPUS PARKING MAP

University of Idaho
Parking and Transportation Services

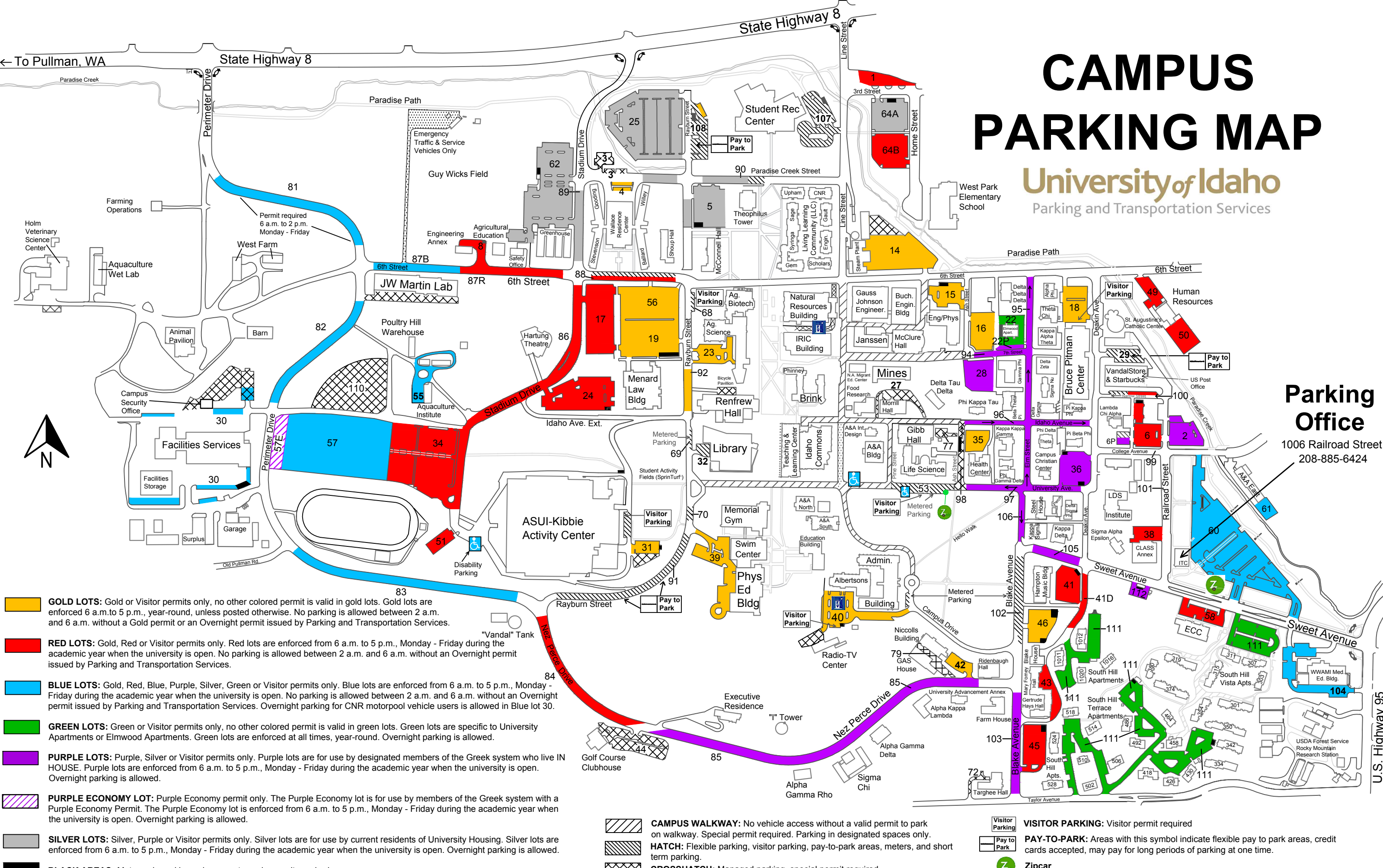

Parking Office
1006 Railroad Street
208-885-6424

- GOLD LOTS:** Gold or Visitor permits only, no other colored permit is valid in gold lots. Gold lots are enforced 6 a.m. to 5 p.m., year-round, unless posted otherwise. No parking is allowed between 2 a.m. and 6 a.m. without a Gold permit or an Overnight permit issued by Parking and Transportation Services.
- RED LOTS:** Gold, Red or Visitor permits only. Red lots are enforced from 6 a.m. to 5 p.m., Monday - Friday during the academic year when the university is open. No parking is allowed between 2 a.m. and 6 a.m. without an Overnight permit issued by Parking and Transportation Services.
- BLUE LOTS:** Gold, Red, Blue, Purple, Silver, Green or Visitor permits only. Blue lots are enforced from 6 a.m. to 5 p.m., Monday - Friday during the academic year when the university is open. No parking is allowed between 2 a.m. and 6 a.m. without an Overnight permit issued by Parking and Transportation Services. Overnight parking for CNR motorpool vehicle users is allowed in Blue lot 30.
- GREEN LOTS:** Green or Visitor permits only, no other colored permit is valid in green lots. Green lots are specific to University Apartments or Elmwood Apartments. Green lots are enforced at all times, year-round. Overnight parking is allowed.
- PURPLE LOTS:** Purple, Silver or Visitor permits only. Purple lots are for use by designated members of the Greek system who live IN HOUSE. Purple lots are enforced from 6 a.m. to 5 p.m., Monday - Friday during the academic year when the university is open. Overnight parking is allowed.
- PURPLE ECONOMY LOT:** Purple Economy permit only. The Purple Economy lot is for use by members of the Greek system with a Purple Economy Permit. The Purple Economy lot is enforced from 6 a.m. to 5 p.m., Monday - Friday during the academic year when the university is open. Overnight parking is allowed.
- SILVER LOTS:** Silver, Purple or Visitor permits only. Silver lots are for use by current residents of University Housing. Silver lots are enforced from 6 a.m. to 5 p.m., Monday - Friday during the academic year when the university is open. Overnight parking is allowed.
- BLACK AREAS:** Motorcycle parking only, no motorcycle permit required.

- CAMPUS WALKWAY:** No vehicle access without a valid permit to park on walkway. Special permit required. Parking in designated spaces only.
- HATCH:** Flexible parking, visitor parking, pay-to-park areas, meters, and short term parking.
- CROSSHATCH:** Managed parking, special permit required.
- DOTS:** No parking. No vehicle traffic.
- VISITOR PARKING:** Visitor permit required
- PAY-TO-PARK:** Areas with this symbol indicate flexible pay to park areas, credit cards accepted, may pay for long periods of parking at one time.
- Zipcar**
- Electric Vehicle (EV) Charging Station**

University of Idaho Disclaimer: The University of Idaho does not guarantee accuracy, scale, content, or layout. We attempt to provide the best available information, but many maps are based on information that may or may not be current or reflect all recent renovations or modifications to a building/site. See our website for further updates, www.uidaho.edu/parking.

University of Idaho

College / Dept	College:	Engineering	Department:	College of Engineering	
Activity Name	Women in Engineering Day	Date:	October 20, 2017	Location:	University of Idaho, Moscow, ID
Participant's Name	(First)	(Last)	(Age)	<input type="checkbox"/> Male	<input type="checkbox"/> Female
Address	(Home Address)			(City, State, Zip)	
Phones	(Cell)			(Home)	
Emergency contact(s) & Insurance info	Primary Contact Name:			(Relationship)	
	WORK PHONE:	HOME PHONE:	CELL:		
	Secondary Contact Name:			(Relationship)	
	WORK PHONE:	HOME PHONE:	CELL:		
PLEASE NOTE: Hospitals and clinics require proof of coverage before providing treatment unless a life threatening situation exists. It is suggested that participants bring a copy of their insurance card. The participant is responsible for all medical expenses.					

Acknowledgment of Risk and Waiver of Liability

Read this carefully and in its entirety. It is a binding legal document. **Sign and return** this form to **University of Idaho College of Engineering Attn: Tanya Gale 875 Perimeter Dr. MS 1011 Moscow, ID 83844-1011**. **If you are under the age of 18, this form must be signed by you as the participant AND by your parent or legal guardian.**

I, the undersigned participant or parent/guardian, am aware that participation in the Women in Engineering Day ("Activity") may include activities that are risky and dangerous. Both participant and his/her parent(s) / guardian(s) ("I") acknowledge and accept the risks and give permission for my participation in the Activity. I acknowledge that participation in this Activity has the following non-exhaustive list of particular activities that **bear risk and danger and from which bodily injury to myself, or my child, up to and including death**, may occur: physical activities, including but not limited to baggage handling, setting up of displays, or touring facilities, while on campus or off, that may involve strenuous exertion that could place stress on cardiovascular and/or musculo-skeletal systems; risks related to transit to or from the Activity locations including, but not limited to, travel by walking or hiking, including travel in unpredictable or extreme weather conditions that affect the method of travel safety; use or operation, by me or others of equipment in the condition in which they are found; exposure to inclement weather including, but not limited to exposure to inclement weather including, but not limited to sun, rain, wind, and extremes of heat that could cause injury or illness including but not limited to heat exhaustion or stroke, sunburn, and dehydration; field trips; contact with ; use of facilities, roads, sidewalks, parking lots, and trails that may or may not be properly maintained; activities supplemental to the Activity, such as walking or hiking to and from sites of interest; exposure to contaminated food and untreated water; risk related to the rendering or receipt of emergency first aid, or other emergency treatment, and transport in medical emergencies; accident or illness in locations without access to appropriate medical facilities or supplies; and other unknown and unanticipated activities and risks.

In consideration of the University of Idaho ("UI") permitting me/my dependent to participate in the Activity, **I and my dependent hereby voluntarily accept all risks associated with participation. To the extent permitted by law, I agree to indemnify, defend, save, hold harmless, discharge and release the State of Idaho, the Regents of the University of Idaho, their agents and employees from any and all liability, claims, causes of action or demands of any kind and nature whatsoever that may arise out of or in connection with my participation in any activities related to the above-named Activity. I understand I am responsible for all medical expenses and/ or property losses.**

It is my express intent that this Acknowledgment of Risk and Waiver of Liability shall serve as a release, discharge and acceptance of risk for my heirs, estate, executor, administrator, assigns and all members of my family.

I acknowledge that the university makes no representation with respect to the safety of any personally owned vehicle in which I may travel, or with respect to the qualifications of the driver of any personally owned vehicle. I understand that if I choose to travel in a personally owned vehicle, it is my responsibility to determine the safety of the vehicle and qualifications of the driver.

I hereby certify that I am in good health and I know of no medical reason why I am not able to participate in the Activity. If I or my dependent has a disability, food or drug allergy, dietary requirements, or any condition requiring accommodation, I will contact Disability Support Services (208) 885-6307 at least one week (7 days) prior to the start of the Activity. I hereby consent to first aid, emergency medical care and if necessary, admission to a hospital when necessary for administering such care, for treatment for injuries or illness that I may sustain while participating in the Activity.

Whether or not I am a student, I will abide by: the University of Idaho Student Code of Conduct, Articles II through IX at <http://www.webs.uidaho.edu/fsh/2300.html>; the behavioral expectations of the Activity; and all applicable city, state and federal laws. My failure to do so may be considered grounds for denying my/my dependent's participation in the Activity.

I agree that you may photograph or video me in connection with the Activity. I agree that you shall be the exclusive owner of all images and all copyright and other rights in the images. I agree that you may use any image in any media you wish related to the University of Idaho. **If you DO NOT GIVE PERMISSION TO PRODUCE OR USE IMAGES, CHECK HERE ().**

I () do () do not **(please check one)** authorize the University of Idaho to use my or my child's/dependent's contact information to inform me/him/her of upcoming university events and activities.

Note: If participant is under 18 years of age, a parent/legal guardian must also sign and accept responsibility for the participant's actions and terms of the above agreement.

PARTICIPANT'S SIGNATURE	PARENT(S) / GUARDIAN(S) SIGNATURE
Participant's Name (PLEASE PRINT):	Parent/ Guardian Name (PLEASE PRINT):
Participant's Signature:	Parent/ Guardian Signature:
X	X
Date:	Date: